

1T65LH(1TM1QSD8E)

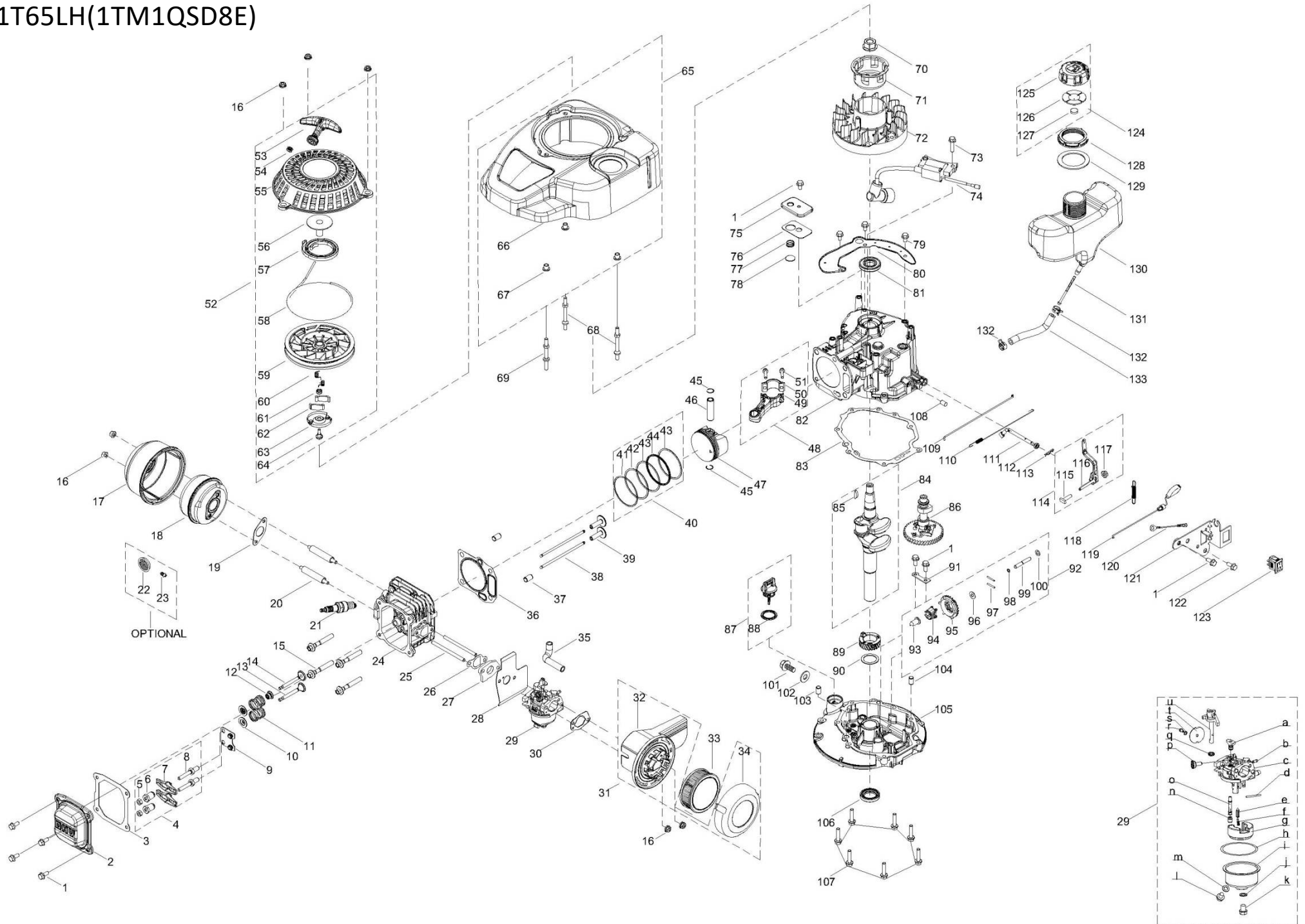

1T65LH 141cc PART LIST -1

| No. | Part No. | Description | Quantity |
|-----|----------------|-------------------------------|----------|
| 1 | 100011262-0003 | Bolt, M6×14 | 8 |
| 2 | 100002308 | Valve Cover | 1 |
| 3 | 100010174 | Gasket, Valve Cover | 1 |
| 4 | 100004421 | Rocker Arm Assembly | 2 |
| 5 | 100004488 | Lock Nut | 2 |
| 6 | 100004457 | Adjust Nut | 2 |
| 7 | 100004438 | Rocker Arm | 2 |
| 8 | 100004492 | Stud | 2 |
| 9 | 100004468 | Rocker Arm Base | 1 |
| 10 | 100004579 | Valve Spring Seat | 2 |
| 11 | 100004564 | Valve Spring | 2 |
| 12 | 100004599 | Intake Valve Seal | 1 |
| 13 | 100004543 | Exhaust Valve | 1 |
| 14 | 100004520 | Intake Valve | 1 |
| 15 | 100002461-0001 | Bolt, M8×54_10.9 | 4 |
| 16 | 100011463-0002 | Nut, M6 | 7 |
| 17 | 100006826 | Muffler Guard | 1 |
| 18 | 100006280 | Muffler | 1 |
| 19 | 100006523 | Gasket, Muffler | 1 |
| 20 | 100010349 | Stud, M6×76 | 2 |
| 21 | 100009383 | Spark Plug | 1 |
| 22 | 100006596 | Spark Arrester | 1 |
| 23 | 100010996-0001 | Self-tapping Screw, ST3.5×9.5 | 1 |
| 24 | 100002370 | Cylinder Head | 1 |
| 25 | 100010348 | Stud, M6×98 | 2 |
| 26 | 100005553 | Gasket, Carburetor Insulator | 1 |
| 27 | 100005596 | Insulator | 1 |
| 28 | 100005920 | Gasket, Carburetor | 1 |
| 29 | 100058074 | Carburetor | 1 |
| 30 | 100005946 | Gasket, Air Filter | 1 |
| 31 | 100004660 | Air Filter Assembly | 1 |
| 32 | 100004988 | Air Filter Base | 1 |

| No. | Part No. | Description | Quantity |
|-----|----------------|-------------------------|----------|
| 33 | 100004764 | Air Filter Element | 1 |
| 34 | 100004837 | Air Filter Cover | 1 |
| 35 | 100002827 | Breather Hose | 2 |
| 36 | 100010202 | Gasket, Cylinder Head | 2 |
| 37 | 100010558 | Pin, φ10×16 | 2 |
| 38 | 100004391 | Push Rod | 1 |
| 39 | 100004261 | Tappet | 1 |
| 40 | 100003235 | Piston Ring Set | 1 |
| 41 | 100003142 | Piston Ring, 1st | 2 |
| 42 | 100003184 | Piston Ring, 2nd | 1 |
| 43 | 100003352 | Scraper Ring, Oil Ring | 2 |
| 44 | 100003311 | Lining Ring, Oil Ring | 1 |
| 45 | 100003220 | Circlip | 1 |
| 46 | 100003118 | Piston Pin | 1 |
| 47 | 100003067 | Piston | 1 |
| 48 | 100003441 | Connecting Rod Assembly | 1 |
| 49 | 100003392 | Connecting Rod | 2 |
| 50 | 100003417 | Connecting Rod Cap | 1 |
| 51 | 100003431 | Connecting Rod Bolt | 1 |
| 52 | 100007221-0001 | Recoil Starter | 1 |
| 53 | 100007459 | Starter Handle | 1 |
| 54 | 100007575 | Starter Handle Insert | 1 |
| 55 | 100007511-0001 | Starter Cover | 1 |
| 56 | 100007678 | Central Shaft | 1 |
| 57 | 100007438 | Recoil Spring | 1 |
| 58 | 100007471 | Starter Rope | 2 |
| 59 | 100007417 | Starter Reel | 1 |
| 60 | 100007448 | Return Spring | 2 |
| 61 | 100007483 | Spring | 1 |
| 62 | 100007427 | Starter Pawl | 1 |
| 63 | 100007433 | Guide Plate | 1 |
| 64 | 100007568 | Alignment Bolt | 1 |

1T65LH 141cc PART LIST -2

| No. | Part No. | Description | Quantity |
|-----|----------------|------------------------------|----------|
| 65 | 100007605 | Blower Housing | 1 |
| 66 | 100051705 | Blower Housing Base | 1 |
| 67 | 100007688 | Bush | 3 |
| 68 | 100010306 | Stud, M6×75 | 2 |
| 69 | 100010307 | Stud, M6×73 | 1 |
| 70 | 100011462-0001 | Nut, M14×1.5 | 1 |
| 71 | 100007557 | Starter Cup | 1 |
| 72 | 100009500 | Flywheel | 1 |
| 73 | 100011268-0003 | Bolt, M6×25 | 1 |
| 74 | 100056743 | Ignition Module | 1 |
| 75 | 100004052 | Breather Cover | 1 |
| 76 | 100010259 | Gasket, Oil Filter | 1 |
| 77 | 100008440 | One-way Vavle Spring | 1 |
| 78 | 100004085 | Breather Valve | 1 |
| 79 | 100011260-0005 | Bolt, M6×10 | 3 |
| 80 | 100007139 | Shield Block | 1 |
| 81 | 100017639 | Oil Seal, φ20×φ42×7 | 1 |
| 82 | 100002621 | Crankcase | 1 |
| 83 | 100010144 | Gasket, Crankcase | 1 |
| 84 | 100003575 | Crankshaft | 1 |
| 85 | 100010577 | Woodruff Key | 1 |
| 86 | 100004281 | Camshaft | 1 |
| 87 | 100004111-0001 | Dipstick | 1 |
| 88 | 100004148 | O-Ring, Dipstick | 1 |
| 89 | 100003467 | Drive Timing Gear | 1 |
| 90 | 100010527-0001 | Washer, φ25.4×1×φ34 | 1 |
| 91 | 100008451 | Governor Gear Mounting Plate | 1 |
| 92 | 100008289 | Governor Gear | 1 |
| 93 | 100008322 | Governor Cup | 1 |
| 94 | 100008334 | Governor Fly Weight | 2 |
| 95 | 100008353 | Governor Gear | 1 |
| 96 | 100031642 | Washer, φ6.2×0.6×φ15 | 1 |

| No. | Part No. | Description | Quantity |
|-----|----------------|--------------------------------|----------|
| 97 | 100008345 | Governor Shaft | 2 |
| 98 | 100008328 | Retaining Ring | 1 |
| 99 | 100008311 | Governor Shaft | 1 |
| 100 | 100010435 | Washer, φ6.2×0.6×φ12 | 1 |
| 101 | 100010272 | Earth Bolt | 1 |
| 102 | 100010459 | Washer, φ10×1.5×φ16 | 1 |
| 103 | 100010554 | Pin, φ9×14 | 1 |
| 104 | 100010544 | Pin, φ7×14 | 1 |
| 105 | 100002949 | Crankcase Cover | 1 |
| 106 | 100017617 | Oil Seal, φ25×φ38×7 | 1 |
| 107 | 100011269-0003 | Bolt, M6×28 | 7 |
| 108 | 100004221 | Bush, φ6.5×φ10×24 | 1 |
| 109 | 100007946 | Throttle Linkage | 1 |
| 110 | 100007919 | Idle Spring | 1 |
| 111 | 100007971 | Governor Gear Shaft | 1 |
| 112 | 100017630 | Oil Seal, φ6×φ11×4 | 1 |
| 113 | 100007986 | Cotter Pin | 1 |
| 114 | 100054663 | Governor Lever | 1 |
| 115 | 100054664 | Bolt, M6×21 | 1 |
| 116 | 100007998 | Governor Lever | 1 |
| 117 | 100011452-0003 | Nut, M6 | 1 |
| 118 | 100007836 | Governor Spring | 1 |
| 119 | 100056744 | Choke Lever | 1 |
| 120 | 100009684 | Earth Wire | 1 |
| 121 | 100008087 | Governor Gear Bracket Assembly | 1 |
| 122 | 100011271-0003 | Bolt, M6×35 | 1 |
| 123 | 100009159 | Stop Switch | 1 |
| 124 | 100008754 | Fuel Cap | 1 |
| 125 | 100008752 | Fuel Cap | 1 |
| 126 | 100010251 | Gasket, Fuel Cap | 1 |
| 127 | 100008809 | Foam | 1 |
| 128 | 100008880 | Lock Nut | 1 |

